

The Charleston





3445 NE 24th Street
 Ocala, Florida 34470
 (352) 387-1597
 CBC1258647
www.NShomes.us

The Charleston

Square Footage

Living: 2,890 Entry: 187
 Garage: 565 Lanai: 472
 Total Under Roof: 4,114

House Features

- 3 Bedroom Plus Study; 2.5 Bath; 2.5 Car Garage
- Gracious Lanai
- Summer Kitchen
- Coffered Ceilings
- Grand Front Entry and Secluded Den/Study
- Optional Porte-Cochere

House Description

Simply spectacular in its creative design, this home boasts elegant symmetry throughout its expansive layout. With every turn, another sensational detail awaits discovery. Archways fill every passage, magnificent coffered ceilings dress most ceilings, and the kitchen is designed for entertaining. Additional features include a discreet utility room, walk-in shower and garden tub in the master bath, gracious lanai & summer kitchen, compartmental guest bath, secluded Den / Study, rearward placed two-car garage, & an optional porte-cochere.



The Charleston

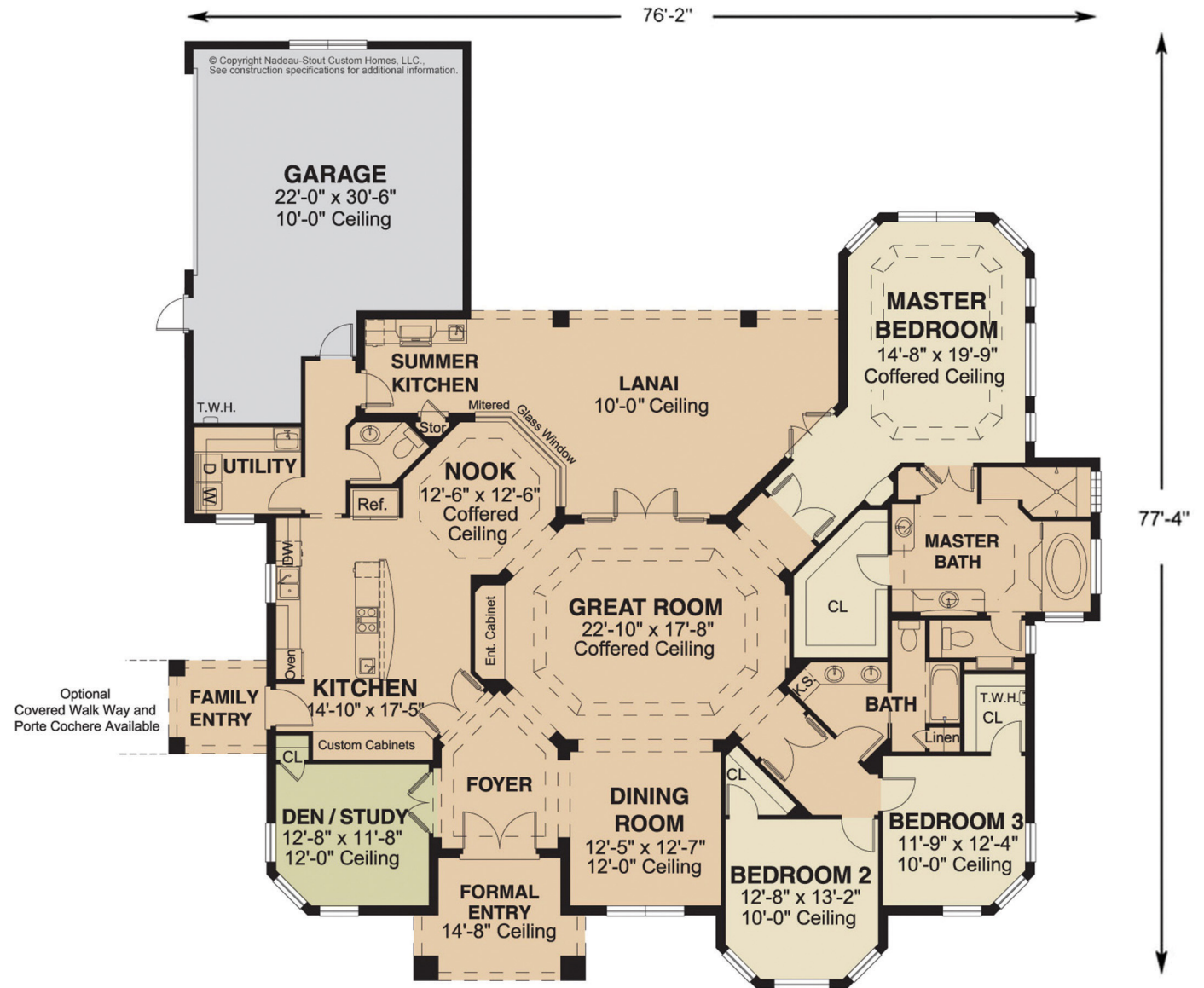

© Copyright Nadeau-Stout Custom Homes, LLC.,
 See construction specifications for additional information.