



CBC1258647

The Buckhorn II



3445 NE 24th Street
Ocala, Florida 34470
Phone: (352) 387-1597

www.NShomes.us

© Copyright Nadeau-Stout Custom Homes, LLC
See construction specifications for additional information.



3445 NE 24th Street
 Ocala, Florida 34470
 (352) 387-1597
 CBC1258647
www.NShomes.us

The Buckhorn II

Square Footage

Living: 2,153 Lanai: 224
 Front Entry: 71 Garage: 556

Total Under Roof: 3,024

House Features

- 3 Bedroom + Study; 2 Bath; 2 Car Garage
- Large Lanai and Luxurious Master Bath
- Task Desk hidden with Sliding Barn-Style Door
- Customization Available

House Description

Building on the incredible floor plan of The Buckhorn, we decided to take the design to the next level by adding a few subtle, but valuable enhancements. Pushing the Study and Garage forward, increases the size of the Kitchen and Great Room. A task desk was added in the Great Room that is easily concealed by a beautiful sliding barn-style door. Both the Kitchen island cabinet and pantry were enlarged. The Utility Room was relocated, enlarged and made to be a secluded space, rather than a room you have to walk through while entering the house from the garage. This gave way to add a "Welcome Home" cabinet for additional organization in the hallway. Lastly, a half bath was added adjacent to the study as well. While these changes do increase the home size a little, the value of them will far out weight the additional investment.



The Buckhorn II

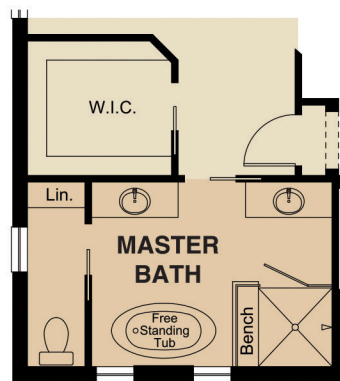

OPTIONAL MASTER BATH LAYOUT 2

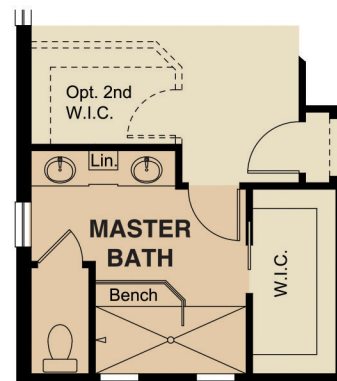

OPTIONAL MASTER BATH LAYOUT 3

© Copyright Nadeau-Stout Custom Homes, LLC.,
 See construction specifications for additional information.

© Copyright Nadeau-Stout Custom Homes, LLC.,
 See construction specifications for additional information.
 *Custom Coffered Ceilings in Great Room and Master Bedroom